

Suttner 600 bar ultra high pressure guns

ST-3600



Professional ultra high pressure gun.  
Max. 600 bar / 80 l/min / 150 °C

R+M Nr.		
203 600 545	1/4" F	1/2" F



Professional ultra high pressure gun.  
Max. 600 bar / 80 l/min / 150 °C

R+M Nr.		
203 600 550	1/2" F	1/2" F



Professional ultra high pressure gun.  
Max. 600 bar / 80 l/min / 150 °C

R+M Nr.		
203 600 570	1/2" F	1/2" F swivel



Professional ultra high pressure gun with coupling ST-45. Max. 600 bar / 80 l/min / 150 °C

R+M Nr.		
203 600 655	coupling ST-45	3/8" F



Professional ultra high pressure gun with coupling ST-45. Max. 600 bar / 80 l/min / 150 °C

R+M Nr.		
203 600 650	coupling ST-45	1/2" F



**ST-3900 shoulder supports.** New European Union guidelines imperatively prescribe the use of shoulder supports for cleaning applications exceeding an operating reaction force of 150 N. Variably adjustable ST-3900. Swiveling coupling. Suitable for guns ST-3600 / ST-3500.

R+M Nr.	telescope	
203 900 500	340 - 500 mm	505 - 675 mm

ST-351 swivels



1/2" M : 1/2" F.  
Max. 600 bar

R+M Nr.
200 351 510



Repair kit swivel ST-351

R+M Nr.
200 351 400

Seal kits ST-740



O-ring

R+M Nr.
050 000 408



Back ring

R+M Nr.
050 000 407

Seal kits ST-3600



R+M Nr.
203 600 490

ST-3600



Professional ultra high pressure gun with extension ST-9 380 mm, grip and quick screw coupling ST-740. Max. 600 bar / 80 l/min / 150 °C

R+M Nr.		
203 600 532	M24 F	M24 M swivel

## Suttner 600 bar ultra high pressure guns



Professional ultra high pressure gun with extension ST-9 380 mm, grip and quick screw coupling ST-740 Max. 600 bar / 80 l/min / 150 °C

R+M Nr.		
203 600 530	M24 F	M24 M

### Ultra high pressure lances



M24 M. Lance 400 mm with nozzle protector ST-10 without nozzle. Lance for ultra high pressure guns with extension ST-9. Max. 600 bar / 150 °C

R+M Nr.		
203 600 470	1/4" F NPT	M24 M

### ST-3600 with lance



Professional ultra high pressure gun with lance 500 mm with grip and sleeve 1/4" F NPT stainless steel without high pressure nozzle. Max. 600 bar / 150 °C

R+M Nr.		
203 600 630	1/4" F NPT	1/2" F

### ST-3600 with lance



Professional ultra high pressure gun with lance 500 mm with grip and sleeve 1/4" F NPT stainless steel without high pressure nozzle. Max. 600 bar / 150 °C

R+M Nr.		
203 600 640	1/4" F NPT	1/2" F swivel

Symbols  inlet  outlet  length

Suttner 500 bar ultra high pressure guns

ST-3600



F

Professional ultra high pressure gun with M22 M. Max. 500 bar / 80 l/min / 150 °C

R+M Nr.		
203 600 556	M22 F	M22 M



Professional ultra high pressure gun. Max. 500 bar / 80 l/min / 150 °C

R+M Nr.		
203 600 555	1/4" F	M22 M



ST-3900 shoulder supports. New European Union guidelines imperatively prescribe the use of shoulder supports for cleaning applications exceeding an operating reaction force of 150 N. Variably adjustable ST-3900. Swiveling coupling. Suitable for guns ST-3600 / ST-3500.

R+M Nr.	telescope	
203 900 500	340 - 500 mm	505 - 675 mm



Professional ultra high pressure gun with extension ST-9 380 mm, grip and M22 M. Max. 500 bar / 80 l/min / 150 °C

R+M Nr.		
203 600 535	M22 F	M22 M

Ultra high pressure lances



M22 M. Lance 335 mm with nozzle protector ST-10 without nozzle. Lance for ultra high pressure guns with extension ST-9. Max. 500 bar / 150 °C

R+M Nr.		
200 000 231	1/4" F NPT	M22 M

Seal kits ST-3600



R+M Nr.	
203 600 490	

ST-2750 - the lightweight among the 500 bar spray guns

ST-2750



LTF

Professional ultra high pressure gun with patented LTF. Max. 500 bar / 30 l/min / 150 °C

R+M Nr.		
202 750 500	1/4" F	3/8" F



LTF

Professional ultra high pressure gun with patented LTF. Max. 500 bar / 30 l/min / 150 °C

R+M Nr.		
202 750 535	M22 F	M22 M



LTF

K

Professional ultra high pressure gun with patented LTF. Gun with insulated outlet suitable for lances with swivel screw coupling. Max. 500 bar / 30 l/min / 150 °C

R+M Nr.		
202 750 570	M22 M	M22 M

## ST-2750 - the lightweight among the 500 bar spray guns

ST-2750



**new**

**LTF**

Professional ultra high pressure gun with patented LTF and lance with insulation ST-9, side handle and nozzle protector ST-10 without high pressure nozzle. Max. 500 bar / 30 l/min / 150 °C

R+M Nr.			ISO		
202 750 900	1/4" F NPT	3/8" F	760 mm	1,000 mm	stainless steel



**LTF**

Professional ultra high pressure gun with extension ST-9.1 240 mm and quick screw coupling ST-740. Max. 500 bar / 30 l/min / 150 °C

R+M Nr.		
202 750 610	M24 F	3/8" F

Valve complete



ST-2750

R+M Nr.
202 750 495

**LTF - Low Trigger Force** 90 % reduced holding force and 40 % reduced trigger force against usual market guns.



**LTF**

Professional ultra high pressure gun with extension ST-9.1 340 mm and quick screw coupling ST-740. Max. 500 bar / 30 l/min / 150 °C

R+M Nr.		
202 750 620	M24 F	3/8" F



**new**

**LTF**

Professional ultra high pressure gun with extension ST-9.1 340 mm and quick screw coupling ST-740. Max. 500 bar / 30 l/min / 150 °C

R+M Nr.		
202 750 621	M24 F	3/8" F swivel

Ultra high pressure lance



M24 M. Lance 400 mm with nozzle protector ST-10 without nozzle. Lance for ultra high pressure guns with extension ST-9.1. Max. 600 bar / 150 °C

R+M Nr.		
203 600 470	1/4" F NPT	M24 M

Shoulder supports



New European Union guidelines imperatively prescribe the use of shoulder supports for cleaning applications exceeding an operating reaction force of 150 N.

R+M Nr.
202 705 590

ST-350 swivel



3/8" M : 3/8" F. Max. 500 bar

Repair kit ST-350

R+M Nr.
200 350 010

R+M Nr.
200 300 120

Symbols inlet outlet length

Suttner ultra high pressure lances

ST-002 ultra high pressure lances



1/4" M. Lance with moulded handle. Safety factor 4. Max. 500 bar / 150 °C

R+M Nr.	☉	ISO	↔	M
070 003 502	1/4" M	300 mm	350 mm	stainless steel
070 008 002	1/4" M	500 mm	800 mm	stainless steel
070 012 002	1/4" M	500 mm	1,200 mm	stainless steel

R+M Nr.

Ultra high pressure twin lances

ST-154



1/4" F. Lance with valve ST-154 aside and nozzle protector ST-10 with low pressure nozzle & thread 1/4" F. Max. 500 bar / 150 °C

R+M Nr.	☉	ISO	↔	M
200 154 510	1/4" F NPT	-	650 mm	stainless steel

R+M Nr.

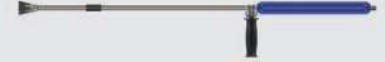

1/4" M. Lance with moulded handle, valve ST-154 aside and nozzle protector ST-10 with low pressure nozzle & thread 1/4" F. Max. 500 bar / 150 °C

R+M Nr.	☉	ISO	↔	M
200 154 500	1/4" F NPT	300 mm	980 mm	stainless steel

R+M Nr.



M22 M. Lance with moulded handle, valve ST-154 aside and nozzle protector ST-10 with low pressure nozzle & thread 1/4" F. Max. 500 bar / 150 °C

R+M Nr.	☉	ISO	↔	M
200 154 520	1/4" F NPT	300 mm	980 mm	stainless steel

R+M Nr.

Symbols ☉ inlet ☉ outlet ↔ length M material ISO insulation

## Suttner ultra high pressure lances

### Ultra high pressure lances ST-3600 - 600 bar



1/2" M. Lance with grip. Max. 600 bar / 150 °C

R+M Nr.	⊖	⊖	⊕	Ⓜ
203 600 416	1/2" M	1,500 mm	1/2" M	stainless steel
203 600 415	1/2" M	2,000 mm	1/2" M	stainless steel

R+M Nr.



1/2" M. Lance with grip and sleeve 1/4" F stainless steel without high pressure nozzle. Max. 600 bar / 150 °C

R+M Nr.	⊖	⊖	⊕	Ⓜ
203 600 400	1/4" F NPT	500 mm	1/2" M	stainless steel
203 600 401	1/4" F NPT	800 mm	1/2" M	stainless steel
203 600 402	1/4" F NPT	1,000 mm	1/2" M	stainless steel

R+M Nr.



1/2" M. Lance with grip for rotating nozzles with 1/4" F without rotating nozzle. Max. 600 bar / 150 °C

R+M Nr.	⊖	⊖	⊕	Ⓜ
203 600 411	1/4" M	500 mm	1/2" M	stainless steel
203 600 410	1/4" M	800 mm	1/2" M	stainless steel
203 600 412	1/4" M	1,000 mm	1/2" M	stainless steel

R+M Nr.



Plug ST-45. Lance with grip and sleeve 1/4" F NPT stainless steel without high pressure nozzle. Max. 600 bar / 150 °C

R+M Nr.	⊖	⊖	⊕	Ⓜ
203 600 444	1/4" F NPT	500 mm	plug ST-45	stainless steel

R+M Nr.



Plug ST-45. Lance with grip for rotating nozzles with 1/4" F without rotating nozzle. Max. 600 bar / 150 °C

R+M Nr.	⊖	⊖	⊕	Ⓜ
203 600 441	1/4" M	800 mm	plug ST-45	stainless steel

R+M Nr.

**Suttner ultra high pressure lances**

Lances with ergonomic swivel screw coupling



M22 M swivel Lance with ergonomic swivel screw coupling, vented handle ST-9 & grip and nozzle protector (M20x1) without tip. Max. 650 bar / 150 °C

R+M Nr.				
200 146 550	nozzle protector	700 mm	M22 F <sub>swivel</sub>	stainless steel

R+M Nr.

**ST-559 Suttner rotating nozzles with carbide insert**

ST-559



1/4" F. 300 - 600 bar. Max. 90 °C

R+M Nr.	
200 559 520	02
200 559 530	03
200 559 540	04
200 559 550	05
200 559 555	055
200 559 560	06



M20x1 F. 300 - 600 bar. Max. 90 °C

R+M Nr.	
200 559 320	02
200 559 330	03
200 559 340	04



Kit ST-559

R+M Nr.
200 559 120
200 559 130
200 559 140
200 559 150
200 559 155
200 559 160

## Cleantecs rotating nozzles with carbide insert

HM 500



Kit  
HM 500



G9/16". Spray angle 20°. Max. 500 bar / 90 °C

R+M Nr.	<b>D</b>
655 500 630	03

R+M Nr.	
655 500 130	

HM 500



Kit  
HM 500



M20x1. Spray angle 20°. Max. 500 bar / 90 °C

R+M Nr.	<b>D</b>
655 500 640	028

R+M Nr.	
655 500 130	

HM 500



Kit  
HM 500



M20x1. Spray angle 20°. Max. 500 bar / 90 °C

R+M Nr.	<b>D</b>
655 500 650	05

R+M Nr.	
655 500 150	

HM 500



Kit  
HM 500



1/4" F. Spray angle 20°. Max. 500 bar / 100 °C

R+M Nr.	<b>D</b>
655 500 520	02
655 500 525	025
655 500 530	03
655 500 535	035
655 500 540	04
655 500 545	045
655 500 550	05
655 500 555	055
655 500 560	06
655 500 570	07

R+M Nr.	
655 500 120	
655 500 125	
655 500 130	
655 500 135	
655 500 140	
655 500 145	
655 500 150	
655 500 155	
655 500 160	
655 500 170	

HM 700



Kit  
HM 700



1/4" F. Spray angle 20°. Max. 700 bar / 100 °C. Delivery time of approx. 1 week

R+M Nr.	<b>D</b>
655 700 520	02
655 700 525	025
655 700 530	03
655 700 535	035
655 700 540	04
655 700 545	045
655 700 550	05
655 700 555	055
655 700 560	06
655 700 570	07

R+M Nr.	
655 700 120	
655 700 125	
655 700 130	
655 700 135	
655 700 140	
655 700 145	
655 700 150	
655 700 155	
655 700 160	
655 700 170	

HM 1000



Kit  
HM 1000



1/4" F. Spray angle 20°. Max. 1,000 bar / 100 °C. Delivery time of approx. 1 week

R+M Nr.	<b>D</b>
655 100 520	02
655 100 525	025
655 100 530	03
655 100 535	035
655 100 540	04
655 100 545	045
655 100 550	05
655 100 555	055
655 100 560	06
655 100 570	07

R+M Nr.	
655 100 120	
655 100 125	
655 100 130	
655 100 135	
655 100 140	
655 100 145	
655 100 150	
655 100 155	
655 100 160	
655 100 170	

Symbols **C** inlet **O** outlet **L** length **M** material **D** nozzle



## Ultra high pressure couplings 500 bar

## Quick screw couplings



M22 F : F. Stainless steel

R+M Nr.	⊙
561 39	M22 : 1/4"
561 59	M22 : 3/8"



M22 F : M. Stainless steel

R+M Nr.	⊙
561 49	M22 : 1/4"
561 69	M22 : 3/8"



Back ring

R+M Nr.	VPE
050 001 440	1
781 021 391 21	100



O-ring

R+M Nr.	VPE
790 24	1
790 241 00	100

## Nipples



M22 M : M. Stainless steel

R+M Nr.	⊙
565 39	M22 : 1/4"
565 59	M22 : 3/8"
565 69	M22 : 1/2"



M22 M : F. Stainless steel

R+M Nr.	⊙
565 29	M22 : 1/4"
565 49	M22 : 3/8"

## Double nipples with 60° cone



M : M. Stainless steel

R+M Nr.	⊙
570 79	3/8" : 3/8"
570 89	3/8" : 1/2"



M : M. Zinc-plated steel

R+M Nr.	⊙
570 78	3/8" : 3/8"
570 88	3/8" : 1/2"

## Hose connectors



DKOS M22 M : M. Stainless steel

R+M Nr.	⊙
593 142	M22 : M22



M22 M : M. Stainless steel

R+M Nr.	⊙
569 59	M22 : M22

M22 M. Solid version stainless steel with rubber cover.  
Max. 500 bar

R+M Nr.
569 49



Rubber

R+M Nr.
569 60

## Straight screw connectors (bicone ring system, heavy duty series)



X-GE. Stainless steel

R+M Nr.	AG : AG	I
596 141 21	M22 : 1/2"	41 mm
596 143 81	M22 : 3/8"	39 mm



X-GE. Zinc-plated steel

R+M Nr.	AG : AG	I
581 141 21	M22 : 1/2"	41 mm

Symbols ⊙ thread VPE packing unit DN nominal diameter I height AG male thread

## Quick screw couplings ST-740 and nipples ST-741

### Quick screw couplings ST-740 and nipples ST-741



M24 F : M.  
Max. 700 bar / 150 °C



M24 F : M.  
Max. 700 bar / 150 °C



M : M24 M.  
Max. 700 bar / 150 °C



M24 M : M24 M.  
Max. 700 bar / 150 °C

⊙
3/8"
1/2"
M24

<b>R+M Nr.</b>
200 740 501
200 740 503

<b>R+M Nr.</b>
200 740 601

<b>R+M Nr.</b>
200 741 501
200 741 503

<b>R+M Nr.</b>
200 741 600



M24 F : F.  
Max. 700 bar / 150 °C



M24 F : F.  
Max. 700 bar / 150 °C



F : M24 M.  
Max. 700 bar / 150 °C

⊙
1/4"
3/8"
M16x1

<b>R+M Nr.</b>
200 740 504
200 740 502
200 740 506

<b>R+M Nr.</b>
200 740 604
200 740 602

<b>R+M Nr.</b>
200 741 504
200 741 502

### Seals



O-ring - ST-740

<b>R+M Nr.</b>
050 000 408



O-ring - ST-741

<b>R+M Nr.</b>
050 001 000



Back ring - ST-740

<b>R+M Nr.</b>
050 000 407

## Suttner ultra high pressure quick couplings ST-45-600

### Couplings and plug ST-45-600



Coupling : M. Stainless steel.  
Max. 600 bar / 150 °C



Coupling : M. Stainless steel.  
Max. 600 bar / 150 °C



Plug : F. Stainless steel.  
Max. 600 bar / 150 °C

⊙	DN
1/4"	8

<b>R+M Nr.</b>	ⓘ
200 045 600	57 mm

<b>R+M Nr.</b>	ⓘ
200 045 605	57 mm

<b>R+M Nr.</b>	ⓘ
040 005 468	40 mm



O-ring, 11x1.5

<b>R+M Nr.</b>
050 000 020



Back ring, 11x14x1

<b>R+M Nr.</b>
050 001 430



O-ring, 10x2.5

<b>R+M Nr.</b>
050 000 160

Ultra high pressure hoses

Hoses with double wire braid and wrapped cover. Type 2SC. Nominal diameter 10. Safety factor 3.5. Fittings stainless steel. Max. 150 °C

Female thread (DKOS)

M22 : M22



maxpressure. Type 2SC. Max. 500 bar

R+M Nr.	Length
358 177 310 9	10 m
358 177 315 9	15 m
358 177 320 9	20 m
358 177 330 9	30 m

Male thread (AGR)

3/8" : 3/8"



maxpressure. Type 2SC. Max. 500 bar

R+M Nr.	Length
358 144 310 9	10 m
358 144 315 9	15 m
358 144 320 9	20 m
358 144 330 9	30 m

Quick screw couplings

M22 : M22

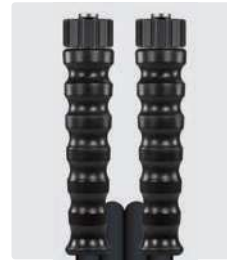

maxpressure. Type 2SC. Max. 500 bar

R+M Nr.	Length
358 100 310 9	10 m
358 100 315 9	15 m
358 100 320 9	20 m
358 100 330 9	30 m



Type 2SC. Max. 500 bar

R+M Nr.	Length
364 100 310 9	10 m
364 100 315 9	15 m
364 100 320 9	20 m
364 100 330 9	30 m

Hoses with double wire braid and wrapped cover. Nominal diameter 10. Fittings stainless steel. Max. 150 °C

Quick screw couplings

M24 : M24



maxpressure. 2SC. Max. 500 bar

R+M Nr.	Length
358 197 310 9	10 m
358 197 315 9	15 m
358 197 320 9	20 m
358 197 330 9	30 m



2SC. Max. 500 bar

R+M Nr.	Length
364 197 310 9	10 m
364 197 315 9	15 m
364 197 320 9	20 m
364 197 330 9	30 m



2SN. Max. 600 bar

R+M Nr.	Length
368 697 610 9	10 m
368 697 615 9	15 m
368 697 620 9	20 m
368 697 630 9	30 m

Hoses with double wire braid and wrapped cover. Nominal diameter 10. Fittings stainless steel. Max. 150 °C

Quick screw couplings : male thread

M24 : M24

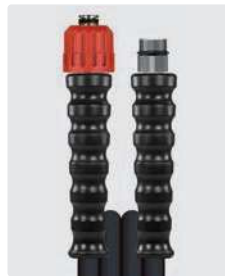

maxpressure. 2SC. Max. 500 bar

R+M Nr.	Length
358 114 431 09	10 m
358 114 431 59	15 m
358 114 432 09	20 m
358 114 433 09	30 m



2SC. Max. 500 bar

R+M Nr.	Length
364 114 471 09	10 m
364 114 471 59	15 m
364 114 472 09	20 m
364 114 473 09	30 m

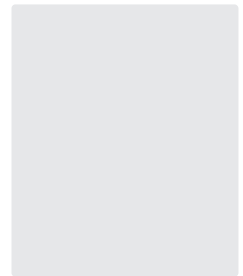

R+M Nr.	Length

Hoses with double wire braid and smooth cover. Nominal diameter 6. Fittings stainless steel. Max. 150 °C

Quick screw couplings / male thread (AGR)

M22 : M22



maxpressure. flexy 500. Max. 500 bar

R+M Nr.	Length
338 000 310 9	10 m
338 000 315 9	15 m
338 000 320 9	20 m
338 000 330 9	30 m

M22 : 1/8"



flexy 500. Max. 500 bar

R+M Nr.	Length
424 300 010 9	10 m
424 300 015 9	15 m
424 300 020 9	20 m
424 300 030 9	30 m

1/4" : 1/4"



flexy 500. Max. 500 bar

R+M Nr.	Length
424 344 010 9	10 m
424 344 015 9	15 m
424 344 020 9	20 m
424 344 030 9	30 m

Hose protection/shroud easyprotect365+

The hose is held close to vital parts of the body, so the danger of bursting hoses for the body is very high. The hose protection provides effective protection for the operator!

It was tested at 500 bar / 7500 psi. An adjustable strap keeps the hose guard securely in place.

The hose protection is very smooth and flexible.



R+M Nr.	Length	Width	Height	Pressure
956 160 045	750 mm	41 mm	500 bar	

## Ultra high pressure swivels

### Elbow swivel



1/2" M : 1/2" F. Inox.  
Max. 600 bar

R+M Nr.

178 261 330 00

### ST-350 swivel



3/8" M : 3/8" F.  
Max. 600 bar

R+M Nr.

200 350 010



Repair kit ST-350

R+M Nr.

200 300 120

### R+M swivel



1/4" F : 3/8" M. Housing  
and axle stainless steel.  
Max. 600 bar / 90 °C

R+M Nr.

750 280 0



Seal kit swivel 750 280 0

R+M Nr.

750 200 2

### ST-351 swivel



1/2" M : 1/2" F.  
Max. 600 bar

R+M Nr.

200 351 510



Repair kit swivel ST-351

R+M Nr.

200 351 400

## Reduction nipple



Stainless steel. 500 bar

R+M Nr.

040 002 207

⊖

1/4" F

⊕

1/8" M

## ST-550 foot valves



Housing stainless steel.  
Valve stainless steel.  
Rubber feet.  
Max. 500 bar / 80 l/min / 150 °C

R+M Nr.

200 550 600

⊖

1/4" F

⊕

1/4" F



Housing stainless steel.  
Valve stainless steel.  
Rubber feet.  
Max. 500 bar / 80 l/min / 150 °C

R+M Nr.

200 550 620

⊖

M22 F

⊕

M22 M

## ST-540 foot valves



Incl. HP-gun ST-2750.  
Material housing powdercoated  
steel.  
Rubber feet.  
Max. 500 bar / 30 l/min / 150 °C

R+M Nr.

200 540 550

⊖

1/4" M

⊕

3/8" F



Incl. HP-gun ST-2750.  
Material housing powdercoated  
steel.  
Rubber feet.  
Max. 500 bar / 30 l/min / 150 °C

R+M Nr.

200 540 560

⊖

M22 M

⊕

M22 M

Symbols ⊖ length ⊕ inlet ⊖ outlet ⊗ diameter ⊐ pressure

Ultra high pressure ball valves ST-3105

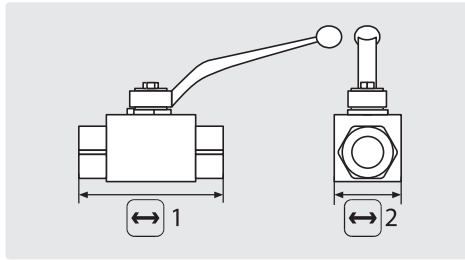

Stainless steel V4A / AISI 316 Ti. Ball stainless steel.  
Max. 500 bar / 80 °C

R+M Nr.	↔ 1	↔ 2	⊙
707 15	69 mm	26 mm	1/4" F
707 25	72 mm	32 mm	3/8" F
707 35	83 mm	35 mm	1/2" F

Sewer cleaning nozzles

Rotating nozzles RT . 1,000 bar

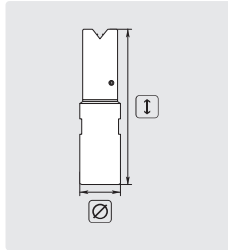

1/8" F. Side jet 2. Front jet 2. Stainless steel.  
Rotating body hp-bronze. Compact model,  
universally applicable. Extreme cleaning  
performance, removes hard deposits. **↑** 80 mm.  
**⊙** 12 mm. Weight 0.18 kg.  
Max. 1,000 bar

R+M Nr.	↔
652 710 006	6 l / 100 bar
652 710 012	12 l / 100 bar
652 710 014	14 l / 100 bar

Rotating nozzles RH . 1,000 bar

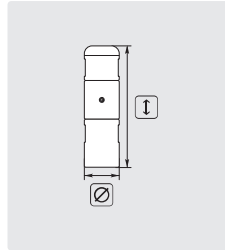

1/8" F. Side jet 2. Stainless steel. Rotating  
body hp-bronze. Compact model, universally  
applicable. Extreme cleaning performance,  
removes hard deposits. **↑** 63 mm. **⊙** 12 mm.  
Weight 0.18 kg.  
Max. 1,000 bar

R+M Nr.	↔
652 810 006	6 l / 100 bar
652 810 010	10 l / 100 bar
652 810 014	14 l / 100 bar

Nozzles for sewer cleaning

Suttner nozzles for sewer cleaning ST-49.3



1/8" F. Nozzle with traction. Stainless steel.  
Hardened stainless steel body. Compact model,  
universally applicable. Extreme cleaning  
performance.  
**⊙** 12 mm.  
Max. 500 bar

R+M Nr.	⊔
200 049 950	05
200 049 970	07

Symbols ↔ length ↑ height ⊙ thread ↔ flow °C temperature ⊔ nozzle ⊘ diameter

## Suttner flow switches

### ST-505 flow switches 600 bar



Floater ST-505 with hole



R+M Nr.	cable
200 005 435	1,200 mm
200 005 438	3,500 mm

Floater VA with hole.  
Contact 1 A - 250 V.

R+M Nr.	mount	closed/open	°C	←	cable	
200 505 706	3/8" F	vertical	3.3/1.8	80	30 l/min	1,200 mm
200 505 709	3/8" F	vertical	2.9/1.7	80	30 l/min	3,600 mm



Floater ST-505 without hole



R+M Nr.	cable
200 005 435	1,200 mm
200 005 438	3,500 mm

Floater brass with hole.  
Contact 1 A - 250 V.

R+M Nr.	mount	closed/open	°C	←	cable	
200 505 708	3/8" F	vertical	0.5/0.1	80	30 l/min	1,200 mm
200 505 711	3/8" F	vertical	0.5/0.1	80	30 l/min	3,600 mm



Floater ST-505 without hole



REED switch

R+M Nr.
200 005 311

R+M Nr.
200 005 438

Floater VA without hole. Contact 1 A - 250 V

R+M Nr.	mount	closed/open	°C	←	cable	
205 505 707	3/8" F	vertical	1.8/1.3	80	30 l/min	1,200 mm

Ultra high pressure regulation valves

VB60/600



☉ = inlet 1/2" F. ☉ = outlet 1/2" F.  
 BP = bypass 1/2" F.  
 Max. 600 bar / 90 °C

H560

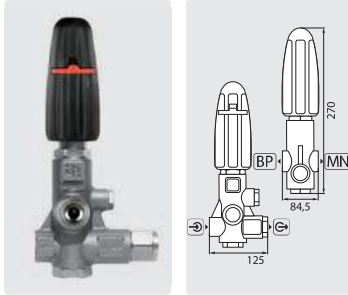

Stainless steel. BP = bypass 1/2" F.  
 MN = pressure gauge 1/4" F.  
 Max. 500 bar / 80 °C / 60 l/min

BKX

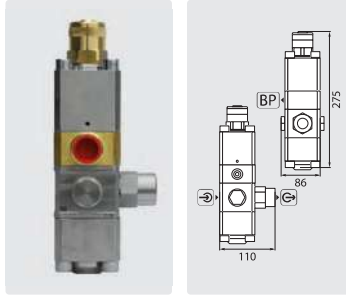

BP = bypass 3/4" F.  
 Max. 600 bar / 80 °C / 60 l/min

VB60/600



☉ = inlet 1/2" F. ☉ = outlet 1/2" F.  
 BP = bypass 1/2" F. Regulation valve with switch (IP55) and cable 950 mm.  
 Max. 600 bar / 90 °C

R+M Nr.	☉	☉
532 260 0	60 l/min	

R+M Nr.	☉	☉
100 005 60	1/2" F	1/2" F

R+M Nr.	☉	☉
010 000 02	1/2" F	1/2" F

R+M Nr.	☉
532 265 0	60 l/min

Ultra high pressure relief valves

VS 500



☉ 222 mm. Max. 500 bar

R+M Nr.	BP	☉
532 520 0	3/8" F	1/2" F

S3



☉ 110 mm. Max. 700 bar

R+M Nr.	☉
010 002 15	1/2" M

ST-230-700 Pressure regulating valve

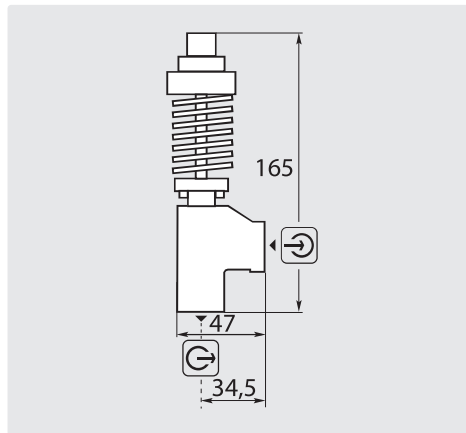

☉ 165 mm. Max. 40 l/min / 60 °C.  
 Short-term max. 85° C

R+M Nr.	☉	☉	P
200 230 700	1/4" F	3/8" F	200-700

Jetbreaker



☉ 27 mm

R+M Nr.	☉
200 230 410	1/4" M

## Safety spectacles, safety goggles and face shields

### Safety spectacles



- » Anti-fog, scratch-proof and antistatic polycarbonate lens
- » Integrated side protection. Including neck cord
- » 100 % UV-protection
- » Protected against shock, splinters and solid particle
- » Weight 25 g

R+M Nr.

956 002 817



- » Anti-fog and scratch-proof polycarbonate smoke lens
- » Panoramac field of vision
- » 100 % UV-protection
- » Protected against shock, splinters and solid particle
- » Weight 30 g

R+M Nr.

956 002 820

### Flip-up face shields



- » Anti-fog, scratch-proof and antistatic polycarbonate lens
- » Adjustable headgear
- » 100 % UV-protection
- » Protected against shock, splinters, solid particle and chemical danger (dangerous drops)
- » Weight 200 g

R+M Nr.

956 003 487

### Safety goggles with temples



- » Anti-fog, scratch-proof and antistatic polycarbonate lens
- » Straight temples with adjustable strap. Integrated side protection. Exchangeable plastic foam rim with indirect ventilation
- » Including microfibre cloth
- » 100 % UV-protection
- » Shockproof in case of extreme temperatures
- » Protected against shock, splinters, solid particle and liquids
- » Weight 52 g

R+M Nr.

956 004 828

### Safety goggles with adjustable strap



- » Anti-fog, scratch-proof and antistatic polycarbonate lens
- » Fits over prescription spectacles. Ball-pivot. Fits with respiratory half mask
- » 100 % UV-protection
- » Shockproof in case of extreme temperatures. Resistant to chemical drops, toxic gases, small and big toxic particle, melting metals and hot solids
- » Weight 113 g

R+M Nr.

956 003 067

### Visor



- » Anti-fog, scratch-proof and antistatic polycarbonate lens
- » Visor in connection with safety goggle 956 003 067
- » Shockproof in case of extreme temperatures. Resistant to chemical drops, toxic gases, small and big toxic particle, melting metals and hot solids
- » Weight 73 g

R+M Nr.

956 003 128

The accident prevention regulations of the Employer's Liability Insurance Association regarding "the use of high pressure cleaner" (BGV D15) and "tasks with liquid jets" (BGV D26) prescribe that adequate eye and face protection have to be worn in case of an operating pressure of 25 bar and more.

Symbols length inlet outlet flow bypass pressure gauges pressure



### easyprotect365+ protection for high pressure cleaning

easyprotect365+ professional protective clothing for abrasive blasting operations up to 500 bar / 7,500 psi.

The strongest fiber in the world for the toughest demands of the world. Thanks Dyneema any application grown to safely master the most difficult tasks.

The perfect protection for people who work professionally with high-pressure cleaner not only in the industry.

#### Comfort, function and safety

Until now there has been no adequate protection for high pressure cleaning.

Nothing that corresponded to the achievements of modern devices or user requirements on comfort and functionality. Our experience with water blasting work at high pressures (up to 500 bar / 7,500 psi) and other personal protective equipment are the basis for our new clothing range. **easyprotect365+** protection for high pressure cleaning.

Ideal protection for abrasive blasting of concrete rehabilitation works, shipyards, petrochemical and steel industry.

#### Apron



- » 3-layer apron with CE certification
- » Security for blasting work up to 500 bar
- » Ideal for work in warm environments
- » Adjustable carrying band, waist band
- » Easy to put on and waterproof
- » Weight 0.7 kg
- » One Size
- » Protection class 5/5/2

R+M Nr.
956 123 501

#### Special gloves



- » Special gloves with CE certification
- » Security for blasting work up to 500 bar
- » Sand-rubber coating for maximum grip
- » Extra inner glove made of nylon
- » Protection class 5 cut 4 abrasion, tear and cut resistance
- » In two sizes 8 / 11
- » Protection class 5/5/2

R+M Nr.	size
956 100 501	8
956 100 502	11

#### Protective boots



- » Protective boots with CE Certification
- » Security for blasting work up to 500 bar
- » Designed for long working in rough conditions
- » Textile lining for maximum comfort
- » Waterproof and anti-slip sole
- » Weight 2.8 kg
- » Sizes 42 - 48
- » Protection class 5/5/3

R+M Nr.	EUR	US	UK
956 152 501	42	9	8
956 152 502	43	9,5	9
956 152 503	44	10,5	10
956 152 504	45	11,5	11
956 152 505	46	12	11,5
956 152 506	47	13	12,5
956 152 507	48	13,5	13,5

#### Protection class 5/5/3

- rotating nozzle 500 bar/7,500 psi
- flat jet 500 bar/7,500 psi
- point jet 300 bar/4,350 psi

CE 89/686/EEC

#### Protection class 5/5/2

- rotating nozzle 500 bar/7,500 psi
- flat jet 500 bar/7,500 psi
- point jet 200 bar/3,000 psi

CE 89/686/EEC

Note - load capacity for point jet:  
300 bar / 4,350 psi